

MARY LOUISE NICHOLSON
COUNTY CLERK

**AMENDMENT TO DECLARATION OF COVENANTS,
RESTRICTIONS AND EASEMENTS FOR MONTRACHET**

This Amendment to Declaration of Covenants, Restrictions and Easements for Montrachet (this "Amendment") is executed to be effective upon recording in the Official Public Records of Tarrant County, Texas.

I.

RECITALS

1.1 This Amendment is made pursuant to the Declaration of Covenants, Restrictions and Easements for Montrachet filed of record in the Official Public Records of Tarrant County, Texas on April 23, 2020, under Instrument No. D220092448 (the "Declaration").

1.2 This Amendment replaces an exhibit in the Declaration.

II.

AMENDMENTS AND ACKNOWLEDGMENTS

2.1 EXHIBIT C-2 on Page 52 of the Declaration regarding Slope Easements is deleted in its entirety and replaced with revised EXHIBIT C-2 as set forth as Exhibit A, attached.

2.2 Except as otherwise expressly provided in this Amendment, the Declaration is hereby ratified and shall remain in full force and effect.

MONTERRAT HILLS, LLC,
a Texas limited liability company

By: 

Donnie Siratt

Title: Member Manager for Montserrat
Properties, LLC as Class B Manager
For Montserrat Hills, LLC

THE STATE OF TEXAS

§
§
§

COUNTY OF TARRANT

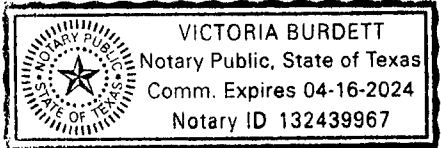

This instrument was acknowledged before me on the 31st day of January, 2023, by Donnie Siratt, the Member Manager of Montserrat Properties, LLC, a Texas limited liability company, as Class B Manager for Montserrat Hills, LLC, a Texas limited liability company, on behalf of such limited liability company.



 Notary Public, State of Texas

Exhibit A (Slope Easement C-2)

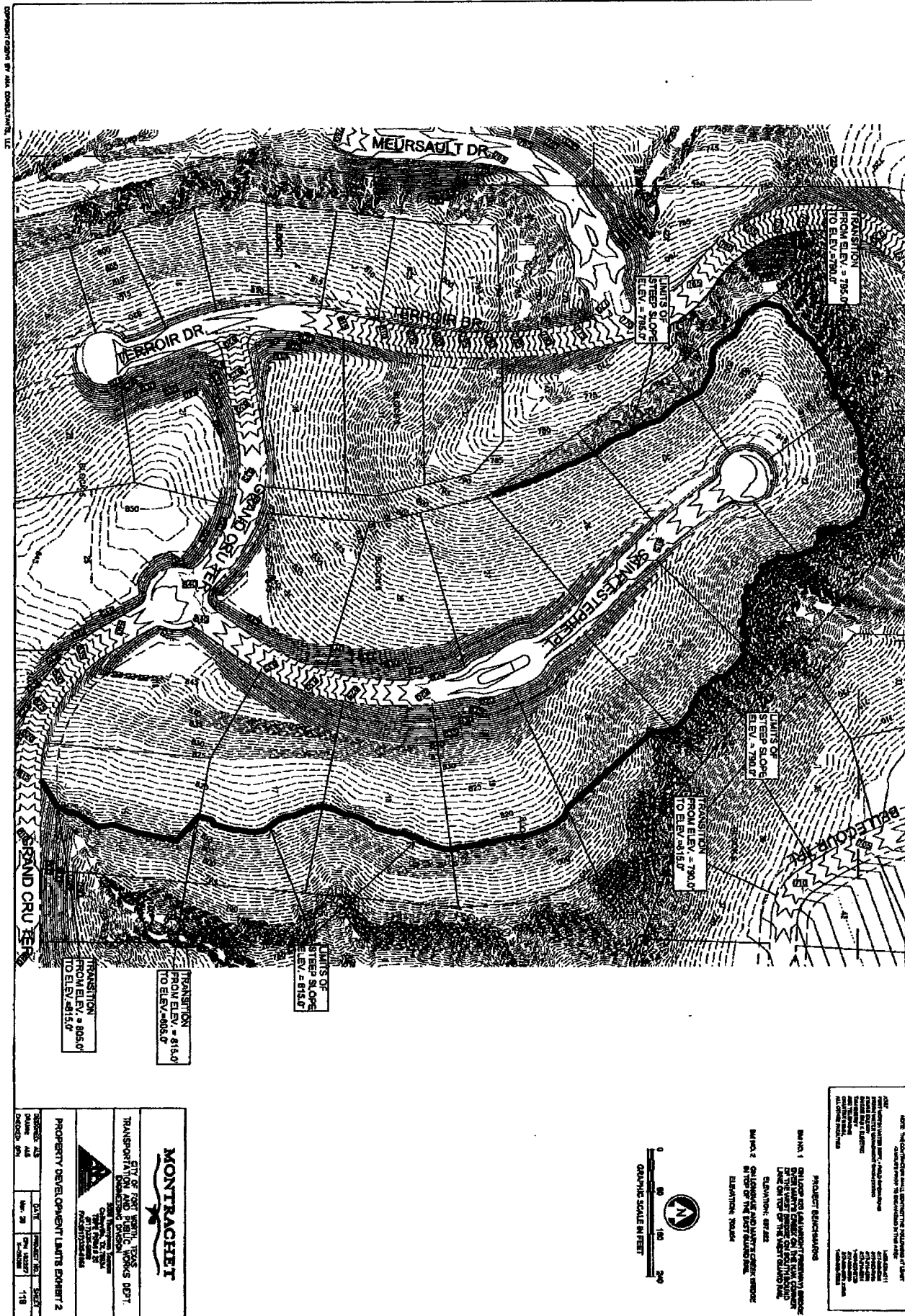

<p>MONTRACHET</p> <p>SITE OF FORT WORTH TEXAS TRANSPORTATION AND PUBLIC WORKS DEPT.</p>	
<p>PROPERTY DEVELOPMENT LIMITS EXHIBIT 2</p>	
<p>DATE: Nov. 28, 1987</p>	<p>PROJECT NO: 118</p>

PROJECT BACKGROUND

THE CITY OF FORT WORTH, TEXAS, HAS BEEN AWARDED A CONTRACT BY THE U.S. ARMY CORPS OF ENGINEERS TO DEVELOP AND CONSTRUCT A NEW BRIDGE OVER THE TEXAS RIVER. THE BRIDGE WILL BE LOCATED ON THE EAST BANK OF THE RIVER, APPROXIMATELY 1.5 MILES WEST OF THE CITY CENTER.

